

◎以上尺寸, 裝入裝配孔(板厚0.6)後量測

◎ HOLE IN CHASSIS:

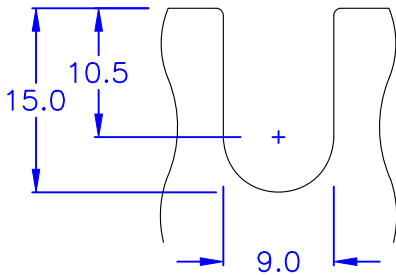

◎ CHASSIS THICKNESS: 0.6 mm

◎Halogen Free 低鹵
◎ROHS 2.0
◎ROHS 六項 compliant

DRAW NO. PGAS029188

GJS

PLASTIC TOLERANCE:

L ≤ 10	±0.2
10 < L ≤ 30	±0.3
30 < L ≤ 50	±0.5
50 < L ≤ 100	±0.7
100 < L ≤ 250	±1.2
ABOVE 250	±1.5

網頁圖示供參考, 最終以品固公司正式圖面為主
The plastic tolerance is just for your reference; all the measurements and dimensions are according to the "DATA SHEET" issued by PINGOOD.

MATERIAL: N66 V2 or EQUIVALENT

COLOR: NATURAL



品固企業股份有限公司
品基電子(東莞)有限公司
蘇州品基電子科技有限公司
東莞市鑽隆商貿有限公司
PINGOOD ENTERPRISE CO.,LTD.

PART NAME:

方型護線環
EDGE SADDLE

A
SIZE

VERSION

1

PART NO:

USM-6M-N2W

SHEET 1 OF 1

	UNIT	SCALE
	mm	