

© ASSEMBLY PART

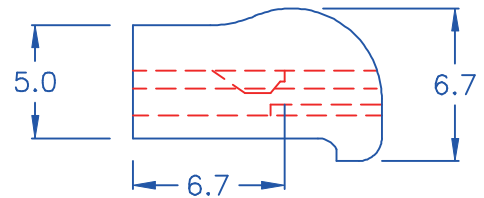
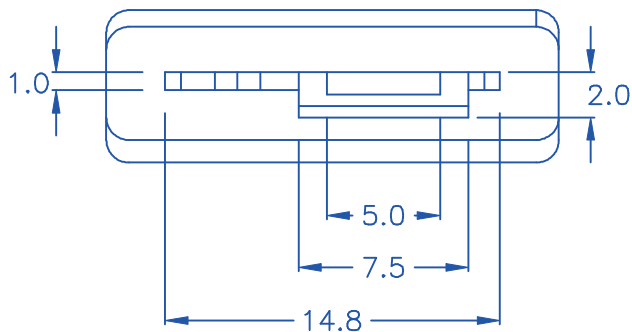
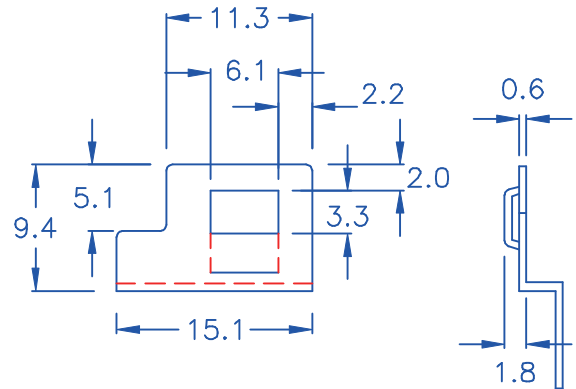
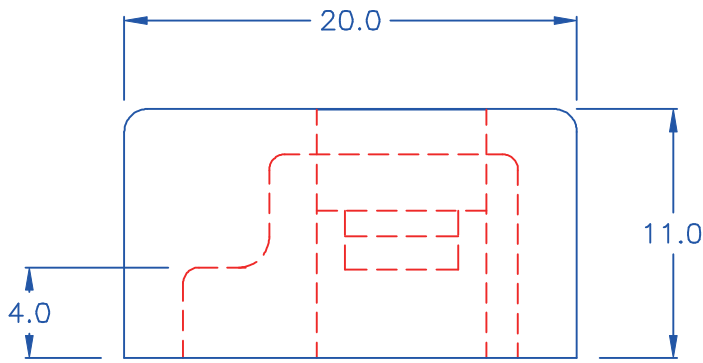

- 1.符合歐盟規範
- ◎ 鎘 (Cd) < 100ppm
- ◎ 鉛 (Pb) < 1000ppm
- ◎ 汞 (Hg) < 1000ppm
- ◎ 六價鉻 (Cr6+) < 1000ppm
- ◎ 多溴聯苯類 (PBB s) < 1000ppm
- ◎ 多溴聯苯醚類 (PBDE s) < 1000ppm
- 2.有鹵

DRAW NO. PGAS020757

GJS

PLASTIC TOLERANCE:

L ≤ 10	±0.2
10 < L ≤ 30	±0.3
30 < L ≤ 50	±0.5
50 < L ≤ 100	±0.7
100 < L ≤ 250	±1.2
ABOVE 250	±1.5

網頁圖示供參考,最終以品固公司正式圖面為主
The plastic tolerance is just for your reference; all the measurements and dimensions are according to the "DATA SHEET" issued by PINGOOD.



品固企業股份有限公司
品基電子(東莞)有限公司
蘇州品基電子科技有限公司
鑽隆有限公司
PINGOOD ENTERPRISE CO.,LTD.

MATERIAL: SANTOPRENE 251-70
or EQUIVALENT

PART NAME:

把手蓋
EJECTOR COVER

A
SIZE

VERSION
2B

COLOR: BLACK

PART NO.:

MHL-06-RYB

SHEET 1 OF 1

	UNIT	SCALE
	mm	

試片硬度: 75°

表單號碼QF135