

◎ HOLE IN DIMENSIONS:

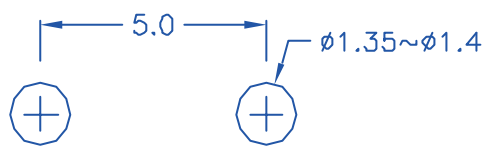

◎ ROHS compliant

DRAW NO. PGAS011245

GJS

PLASTIC TOLERANCE:		
$L \leq 10$	$\pm 0.2$	
$10 < L \leq 30$	$\pm 0.3$	
$30 < L \leq 50$	$\pm 0.5$	
$50 < L \leq 100$	$\pm 0.7$	
$100 < L \leq 250$	$\pm 1.2$	
ABOVE 250	$\pm 1.5$	

網頁圖示供參考, 最終以品固公司正式圖面為主  
The plastic tolerance is just for your reference; all the measurements and dimensions are according to the "DATA SHEET" issued by PINGOOD.



品固企業股份有限公司  
品基電子(東莞)有限公司  
蘇州品基電子科技有限公司  
鑽隆有限公司  
PINGOOD ENTERPRISE CO.,LTD.

MATERIAL: BRASS

PLATING: MATTE TIN

PART NAME:

端子  
CONNECTOR

PART NO:

JP-14-CXS

A

SIZE

REV.

1

	UNIT	SCALE
	mm	

SHEET 1 OF 1

EF0404505