

◎ HOLE IN CHASSIS:

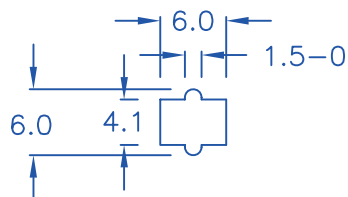

◎ CHASSIS THICKNESS: 1.6 mm

◎HF
◎ROHS compliant

DRAW NO. PGAS014351

GJS

PLASTIC TOLERANCE:

| | |
|--------------------|-----------|
| $L \leq 10$ | ± 0.2 |
| $10 < L \leq 30$ | ± 0.3 |
| $30 < L \leq 50$ | ± 0.5 |
| $50 < L \leq 100$ | ± 0.7 |
| $100 < L \leq 250$ | ± 1.2 |
| ABOVE 250 | ± 1.5 |

網頁圖示供參考, 最終以品固公司正式圖面為主

The plastic tolerance is just for your reference; all the measurements and dimensions are according to the "DATA SHEET" issued by PINGOOD.

MATERIAL: N66 V2 or EQUIVALENT

COLOR: NATURAL



品固企業股份有限公司
品基電子(東莞)有限公司
蘇州品基電子科技有限公司
鑽隆有限公司
PINGOOD ENTERPRISE CO.,LTD.

PART NAME:

直立式導槽
PCB GUIDE RAIL

PART NO:

HCG-5

A

SIZE

VERSION

3

SHEET 1 OF 1

EF0404505



UNIT
mm

SCALE
1:1