

下壓頂出裝置，產生扣住功能時，距外殼頂端距離位置為2.7mm(衝程至少需1.2mm)

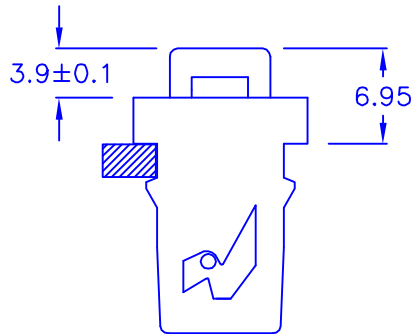

頂端位置
距離卡板頂端 3.85 ± 0.1 mm

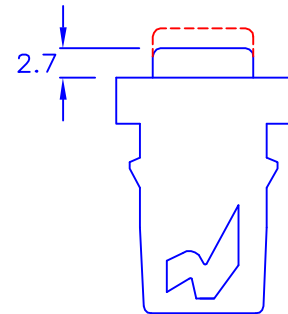

扣住後欲退出
需再下壓解除扣住功能，距外殼頂端距離位置為2.7mm(衝程至少需1.2mm)

◎ CHASSIS THICKNESS: 2.0 mm

◎ HOLE IN DIMENSIONS:

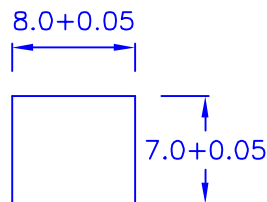

◎HF
◎ROHS compliant

DRAW NO. PGAS018651

GJS

PLASTIC TOLERANCE:		
L ≤ 10	±0.2	
10 < L ≤ 30	±0.3	
30 < L ≤ 50	±0.5	
50 < L ≤ 100	±0.7	
100 < L ≤ 250	±1.2	
ABOVE 250	±1.5	

網頁圖示供參考，最終以品固公司正式圖面為主
The plastic tolerance is just for your reference; all the measurements and dimensions are according to the "DATA SHEET" issued by PINGOOD.



品固企業股份有限公司
品基電子(東莞)有限公司
蘇州品基電子科技有限公司
鑽隆有限公司
PINGOOD ENTERPRISE CO.,LTD.

外殼材質: P.C V2 or EQUIVALENT
扣具頂出裝置材質:
N66 V2 or EQUIVALENT

PART NAME:
門扣
PUSH LATCH

A SIZE	VERSION
	3A

COLOR: BLACK

PART NO:
DL-400P

SHEET 1 OF 1

UNIT	SCALE
mm	