

HOLE IN CHASSIS
CHASSIS THICKNESS: 2.0mm

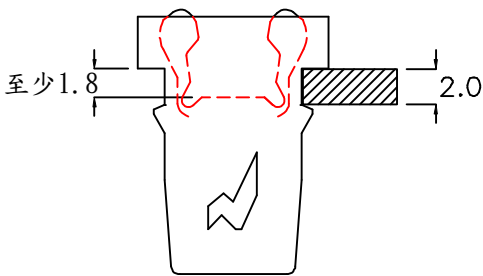

夾子欲下壓產生扣住功能時
行程距離卡板頂端衝程
至少需1.8mm
Maximum Push-IN Position

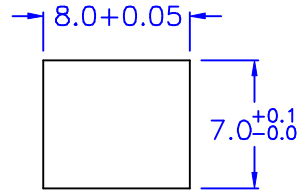
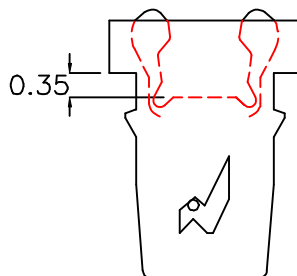

夾子扣住時
夾子頂端位置
距離卡板頂端
0.35mm
Close Position

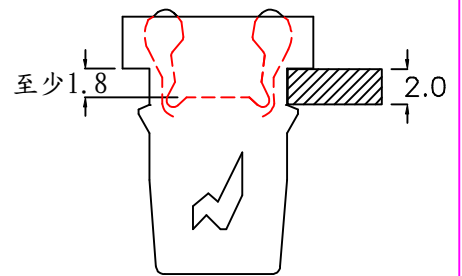

夾子欲下壓產生
退出扣住功能時
行程距離卡板頂端衝程
至少需1.8mm
Maximum Push-Out Position

◎常溫耐久承受力0.25kg

◎Halogen Free

DRAW NO. PGAS026463

GJS

| | |
|--------------------|------|
| PLASTIC TOLERANCE: | |
| L ≤ 10 | ±0.2 |
| 10 < L ≤ 30 | ±0.3 |
| 30 < L ≤ 50 | ±0.5 |
| 50 < L ≤ 100 | ±0.7 |
| 100 < L ≤ 250 | ±1.2 |
| ABOVE 250 | ±1.5 |

網頁圖示供參考, 最終以品固公司正式圖面為主
The plastic tolerance is just for your reference; all the measurements and dimensions are according to the "DATA SHEET" issued by PINGOOD.

外殼材質: PC V2 or EQUIVALENT

夾子材質: N66 V2 or EQUIVALENT

COLOR: BLACK



品固企業股份有限公司
品基電子(東莞)有限公司
蘇州品基電子科技有限公司
鑽隆有限公司
PINGOOD ENTERPRISE CO.,LTD.

PART NAME:

門扣
PUSH LATCH

PART NO:

DL-100B

A

SIZE

VERSION

4C

SHEET 1 OF 1

| | | |
|--|------|-------|
| | UNIT | SCALE |
| | mm | |

表單號碼QF135