

◎ HOLE IN CHASSIS:

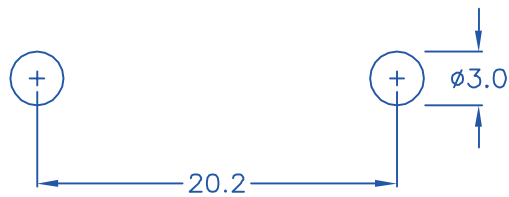

◎ MAXIMUM THICKNESS: 1.2 mm

◎HF  
◎ROHS compliant

DRAW NO. PGASQ16825

GJS

PLASTIC TOLERANCE:	
$L \leq 10$	$\pm 0.2$
$10 < L \leq 30$	$\pm 0.3$
$30 < L \leq 50$	$\pm 0.5$
$50 < L \leq 100$	$\pm 0.7$
$100 < L \leq 250$	$\pm 1.2$
ABOVE 250	$\pm 1.5$

網頁圖示供參考, 最終以品固公司正式圖面為主  
The plastic tolerance is just for your reference; all the measurements and dimensions are according to the "DATA SHEET" issued by PINGOOD.



品固企業股份有限公司  
品基電子(東莞)有限公司  
蘇州品基電子科技有限公司  
鑽隆有限公司  
PINGOOD ENTERPRISE CO.,LTD.

MATERIAL: N66 V2 or EQUIVALENT  
COLOR: NATURAL

PART NAME:

印刷電路板導槽  
PCB GUIDE RAIL

A  
SIZE

VERSION  
3A

PART NO:

CG-4A

SHEET 1 OF 1

UNIT	SCALE
mm	

表單號碼QF135