

總類: 標準平齒輪
 齒型: 漸開式
 壓力角: 20°
 齒數: 11
 節徑: $\phi 8.8$
 模數: 0.8
 齒外徑: $\phi 10.5$
 扭力: 100 ± 20 gf-cm (溫度: 23°C)
 轉速: 15 RPM
 * 扭力會隨溫度及轉速而有所差異

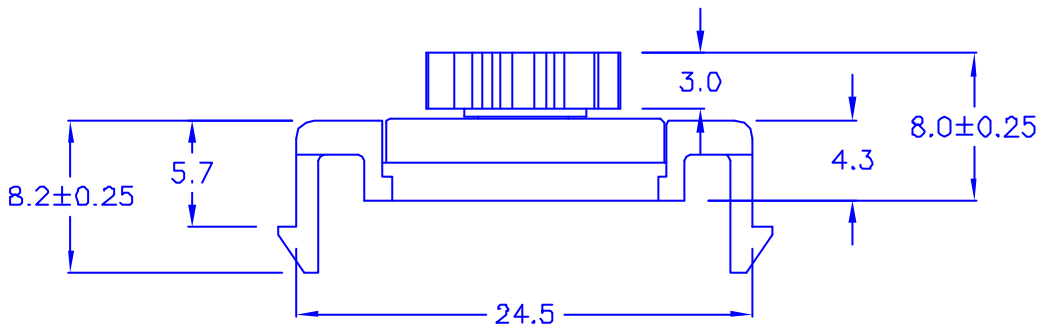
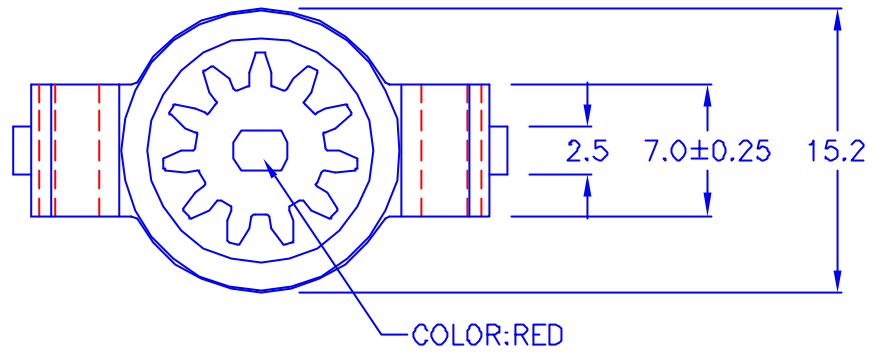

©ROHS compliant

DRAW NO. PGAS014445 GJS

PLASTIC TOLERANCE:
 $L \leq 10 \pm 0.2$
 $10 < L \leq 30 \pm 0.3$
 $30 < L \leq 50 \pm 0.5$
 $50 < L \leq 100 \pm 0.7$
 $100 < L \leq 250 \pm 1.2$
 ABOVE 250 ± 1.5

網頁圖示供參考, 最終以品固公司正式圖面為主
 The plastic tolerance is just for your reference; all the measurements and dimensions are according to the "DATA SHEET" issued by PINGOOD.



品固企業股份有限公司
 品基電子(東莞)有限公司
 蘇州品基電子科技有限公司
 鑽隆有限公司
 PINGOOD ENTERPRISE CO.,LTD.

MATERIAL:
 POM 94HB or EQUIVALENT
 ABS 94HB or EQUIVALENT

PART NAME:
 塑膠阻尼器
 ROTARY DAMPER

A	VERSION
	1
SIZE	

	UNIT	SCALE
	mm	

COLOR: BLACK

PART NO:
 PG-8AS-100R

SHEET 1 OF 1

EF0404505