

◎ HOLE IN CHASSIS :

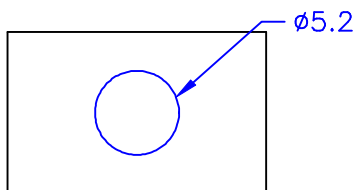

◎ CHASSIS THICKNESS: 1.6 mm

- 1.符合歐盟規範
 ◎ 鎘 (Cd) < 100ppm
 ◎ 鉛 (Pb) < 1000ppm
 ◎ 汞 (Hg) < 1000ppm
 ◎ 六價鉻 (Cr6+) < 1000ppm
 ◎ 多溴聯苯類 (PBB s) < 1000ppm
 ◎ 多溴聯苯醚類 (PBDE s) < 1000ppm
 2.有鹵

DRAW NO. PGAS020908

GJS

PLASTIC TOLERANCE:

L < 10	±0.3
L ≥ 10	±0.5
ABOVE 80	±1.0

網頁圖示供參考, 最終以品固公司正式圖面為主
 The plastic tolerance is just for your reference; all the measurements and dimensions are according to the "DATA SHEET" issued by PINGOOD.



品固企業股份有限公司
 品基電子(東莞)有限公司
 蘇州品基電子科技有限公司
 鑽隆有限公司
 PINGOOD ENTERPRISE CO.,LTD.

MATERIAL: TPV or EQUIVALENT

COLOR: BLACK

PART NAME:

塞頭
 HOLE PLUG

A

VERSION

SIZE

1

PART NO:

MAF-4D-GRB

SHEET 1 OF 1

	UNIT	SCALE
	mm	