

◎ HOLE IN :

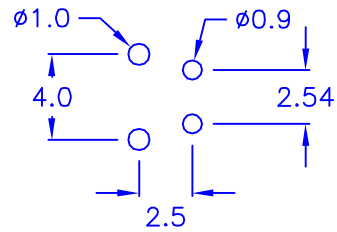

◎ CHASSIS THICKNESS: 1.6mm

◎ROHS compliant

DRAW NO. PGAS015658

GJS

PLASTIC TOLERANCE: L≤10 ±0.2 10<L≤30 ±0.3 30<L≤50 ±0.5 50<L≤100 ±0.7 100<L≤250 ±1.2 ABOVE 250 ±1.5	網頁圖示供參考,最終以品固公司正式圖面為主 The plastic tolerance is just for your reference; all the measurements and dimensions are according to the "DATA SHEET" issued by PINGOOD.
	MATERIAL: N66 V2 or EQUIVALENT COLOR: BLACK



品固企業股份有限公司
 品基電子(東莞)有限公司
 蘇州品基電子科技有限公司
 鑽隆有限公司
 PINGOOD ENTERPRISE CO.,LTD.

PART NAME:
LED 座
 LED HOUSING

A	VERSION
	2
SIZE	

PART NO:
 LET5-5A-N2B

SHEET 1 OF 1

	UNIT	SCALE
	mm	