

HOLE IN CHASSIS
CHASSIS THICKNESS: 2.0mm

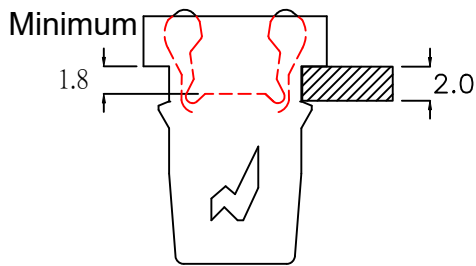

Maximum Push-IN Position

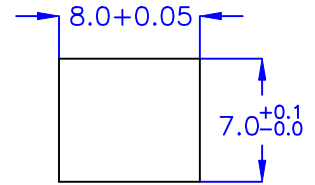
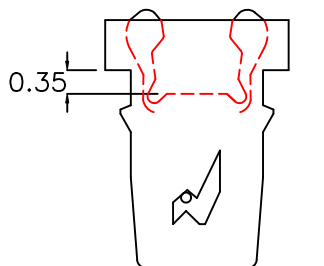

Close Position

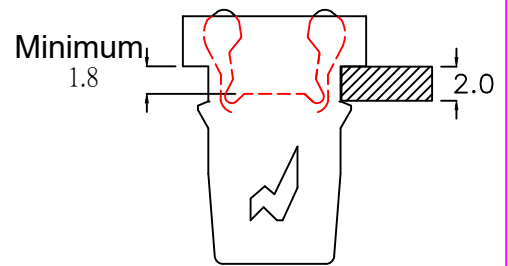

Maximum Push-Out Position

©The normal temperature durability 0.25 kg

©Halogen Free

DRAW NO. PGAS027178

GJS

PLASTIC TOLERANCE: L ≤ 10 ± 0.2 10 < L ≤ 30 ± 0.3 30 < L ≤ 50 ± 0.5 50 < L ≤ 100 ± 0.7 100 < L ≤ 250 ± 1.2 ABOVE 250 ± 1.5		網頁圖示供參考, 最終以品固公司正式圖面為主 The plastic tolerance is just for your reference; all the measurements and dimensions are according to the "DATA SHEET" issued by PINGOOD.
HOUSING MATERIAL: PC V2 or EQUIVALENT		PART NAME: PUSH LATCH
CLIP MATERIAL: N66 V2 or EQUIVALENT		
COLOR: BLACK		VERSION A 1



品固企業股份有限公司
品基電子(東莞)有限公司
蘇州品基電子科技有限公司
鑽隆有限公司
PINGOOD ENTERPRISE CO.,LTD.

	UNIT	SCALE
	mm	

PART NO:
DL-100B

SHEET 1 OF 1