

HOLE IN CHASSIS
CHASSIS THICKNESS: 2.0mm

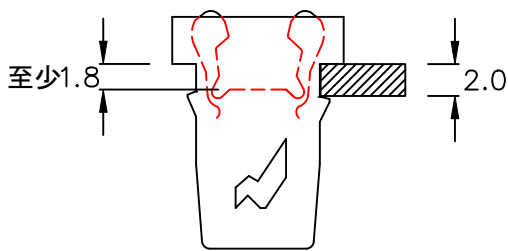

夾子欲下壓產生扣住功能時
行程距離卡板頂端衝程
至少需1.8mm
Maximum Push-IN Position

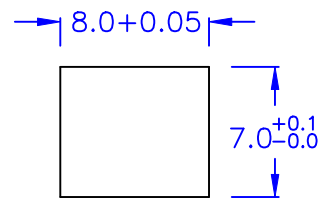
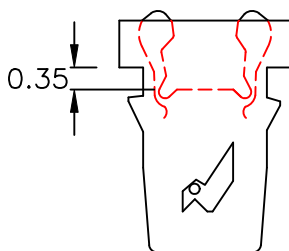

夾子扣住時
夾子頂端位置
距離卡板頂端
0.35mm
Close Position

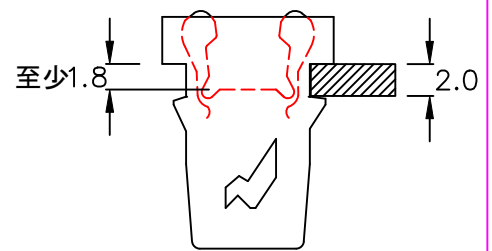

夾子欲下壓產生退出扣住功能時
行程距離卡板頂端衝程
至少需1.8mm
Maximum Push-OUT Position

◎常溫耐久承受力0.25kg
* 內部裝有線徑 0.3 mm 之彈簧.

◎Halogen Free 低鹵

DRAW NO. PGAS029636

GJS

PLASTIC TOLERANCE:	
L ≤ 10	±0.2
10 < L ≤ 30	±0.3
30 < L ≤ 50	±0.5
50 < L ≤ 100	±0.7
100 < L ≤ 250	±1.2
ABOVE 250	±1.5

網頁圖示供參考,最終以品固公司正式圖面為主
The plastic tolerance is just for your reference; all the measurements and dimensions are according to the "DATA SHEET" issued by PINGOOD.

外殼材質: PC V2 or EQUIVALENT

夾子材質: N66 V2 or EQUIVALENT

COLOR: BLACK



品固企業股份有限公司
品基電子(東莞)有限公司
蘇州品基電子科技有限公司
東莞市鑽隆商貿有限公司
PINGOOD ENTERPRISE CO.,LTD.

PART NAME:

門扣
PUSH LATCH

A
SIZE

VERSION
6E

PART NO:

DL-100A

SHEET 1 OF 1

UNIT	SCALE
mm	

表單號碼QF135